

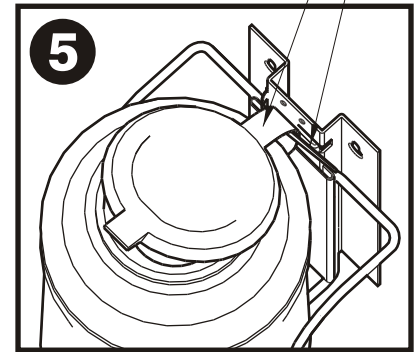

SANI-BRACKET®
3-IN-1 CANISTER HOLDER
ASSEMBLY INSTRUCTIONS
FOR USE WITH REORDER # P010701/P010901

NICEPAK®
commercial

- 1** Position the back plate as needed for the medium, large or x-large canister (see back chart for proper hole location) by pulling the spring button out from behind. Slide the plate to the desired location and release the button.
- 2** Position the front plate in the same way as the back plate. See Page 2 for proper position.
- 3** Mount the wall plate in desired location (screws not supplied). Use anchors or screws that are compatible with the wall material or other hard surface.
- 4** To install the canister into the bracket, position the bottom in first with canister lid in open position, rotate can/lid to hook the hinge of the canister lid under the spring pin.
- 5** When assembled correctly the completed bracket should look like the example in figure 5.
- 6** Optional: For added security, attach a plastic zip tie around the lid's hinge and through 2 holes above the spring pin as shown in figure 6.

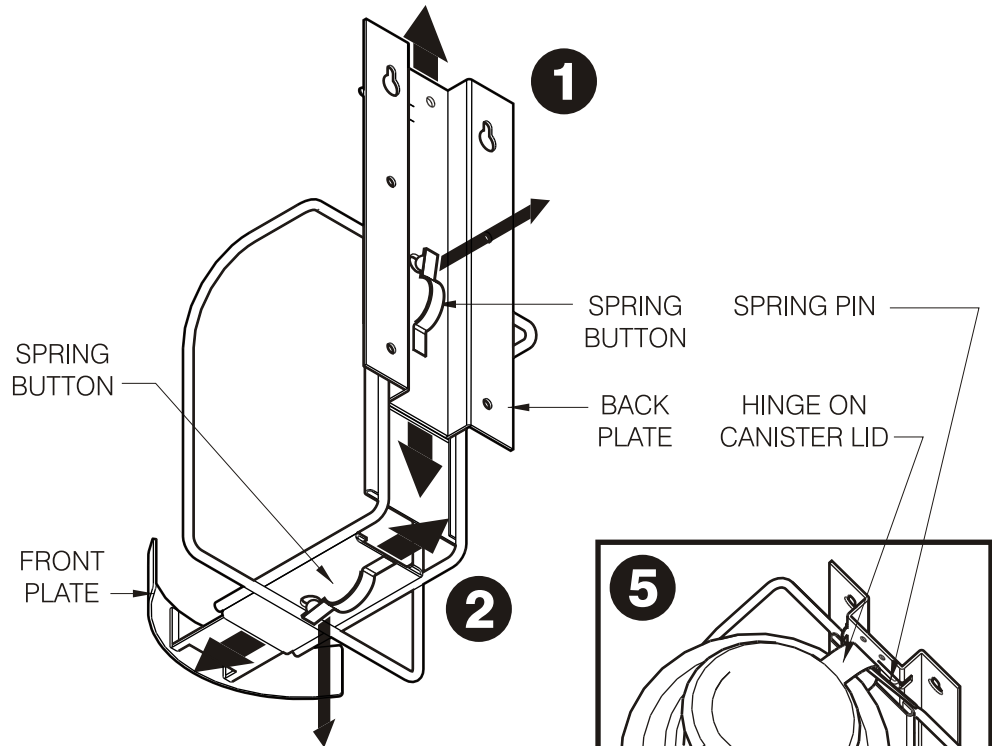

SHOWN COMPLETE

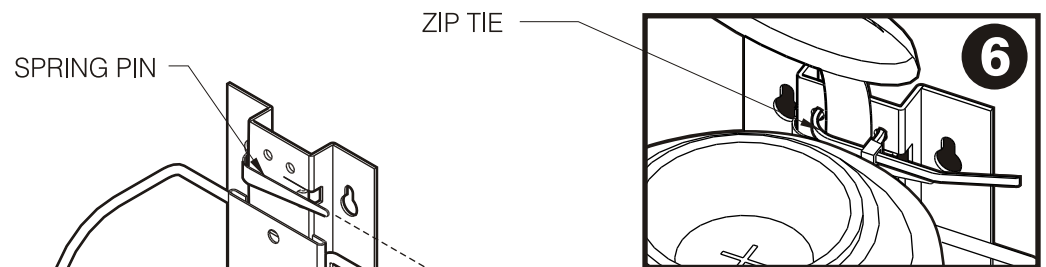

OPTIONAL

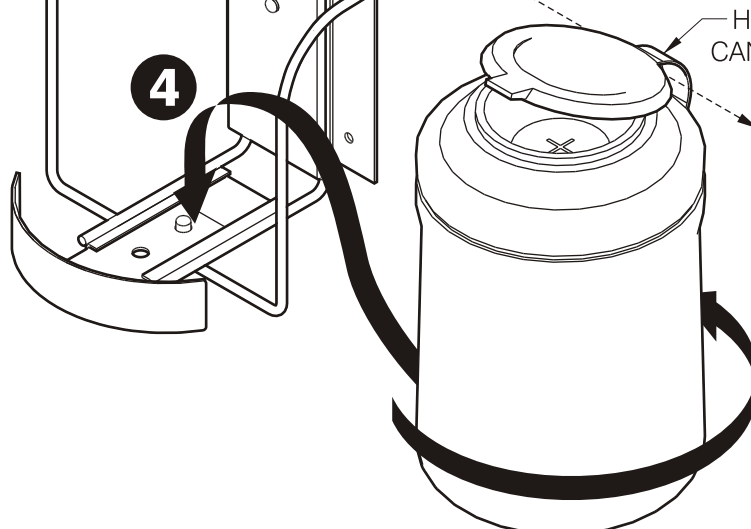
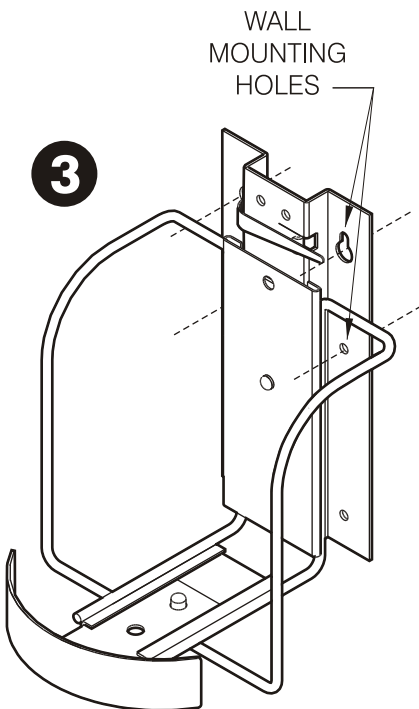

SANI-BRACKET® 3-IN-1 CANISTER HOLDER ADJUSTMENT GUIDE
FOR DETERMINING PROPER HOLE LOCATION AS REQUIRED FOR DIFFERENT SIZE CANISTERS

MEDIUM CANISTER (135 WIPE COUNT)

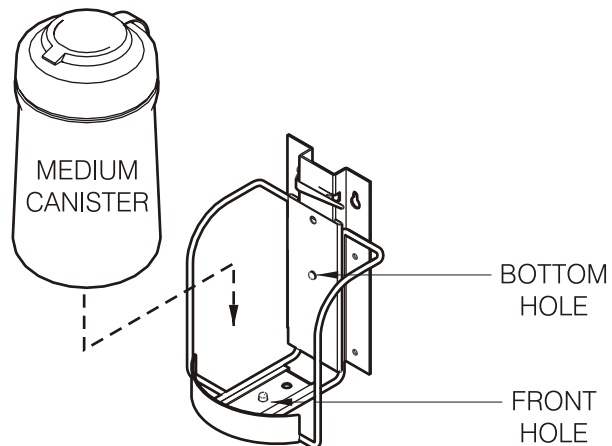

LARGE CANISTER (160 OR 220 WIPE COUNT)

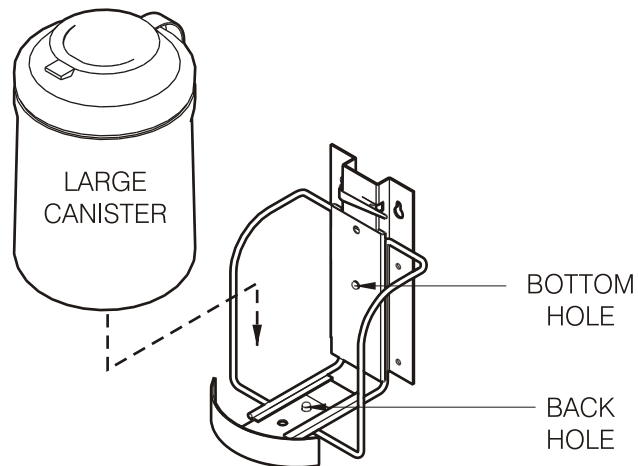

EXTRA LARGE CANISTER (50, 65 OR 100 WIPE COUNT)

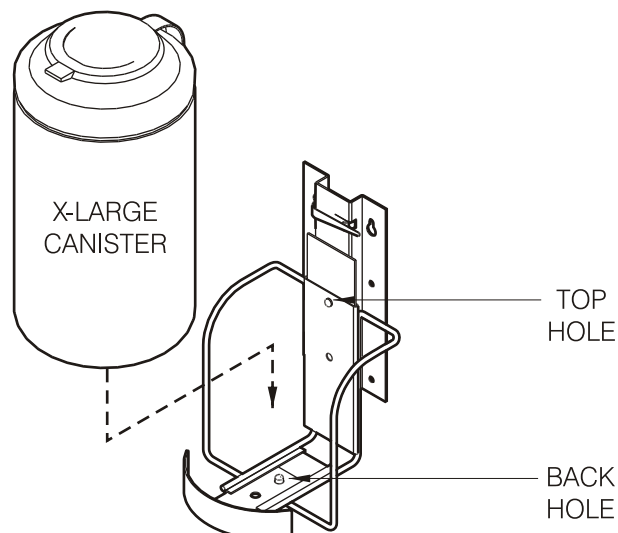

Manufactured for Professional Disposables International, Inc.
Two Nice-Pak Park, Orangeburg, NY 10962-1376 • USA

1-800-999-6423 • www.pdipdi.com • www.nicepak.com/commercial

Nice-Pak is used under license by Professional Disposables International, Inc.